

16-2-75

Rugby League's richest prize!

# Player's N°6 Trophy

The outstanding feature of every season



With over £16,000 in prize money to play for it's no wonder that the Player's N°6 Trophy is a success with the players. And the effort and skill they put into capturing the Trophy has made sure that this 5 round, 32 club knockout series is a hit with the spectators too.

The Player's N°6 Trophy really is Rugby League's richest prize—in every sense.



PNS 649

## LEIGH FOOTBALL CLUB LIMITED

Leigh 4

Oldham 18



OFFICIAL PROGRAMME

PRICE 7p.



You're Welcome Here,  
So be of Good Cheer,  
And Drink Good Beer  
at Your Local . . .

## RAILWAY INN

(FLORENCE and ALAN)

### TETLEY WALKER ALES

\*MEALS \* LUNCHES \* SNACKS

Call and see us before and after the match

KIRKHALL LANE - LEIGH

Telephone: 74197

\* 12 SEATER VEHICLES AVAILABLE \*

Contact us now with your Party Requirements.

## Redway Coaches

SATISFACTION ASSURED

71, TWIST LANE - LEIGH

Telephone: LEIGH 76655

Private: LEIGH 4328

## HEADLINE!

Announcing the Opening of Leigh's newest Hair Salon for Men

## HEADLINE

is our name. Phone now for appointment - LEIGH 75513

HAIR CUTTING & STYLING TO SUIT ALL TASTES.

ONCE ADMISSION HAS BEEN GAINED TO THE

GROUND, UNDER NO CIRCUMSTANCES

CAN MONEY BE REFUNDED

## LEIGH FOOTBALL CLUB LIMITED

Ground—HILTON PARK

Colours—Cherry and White Hooped Jerseys, White Shorts  
Telephones: 71084 & 5519

President—Sir WILLIAM BARKER, K.C.M.G., O.B.E:

### DIRECTORS

Chairman—JOHN B. HARDING, Esq., F.C.A.

Vice-Chairman—J. S. ROBERTS, Esq.

C. H. COLLIER, Esq.

G. McDONALD, Esq:

H. HULMES, Esq.

B. BOWMAN, Esq.

E. DENISON, Esq.

J. BYRNE, Esq.

T. SALE, Esq.

Secretary—JOHN STRINGER

Hon. Solicitor—Mr. C. J. WILKINSON

Coach—EDDIE CHEETHAM

Assistant Coach—TONY BARROW

### SECOND DIVISION GAME

## LEIGH v. OLDHAM

Sunday, 16th February, 1975

Kick-off 3-30 p.m.

**WILL YOUR COMPANY DONATE A  
MATCH BALL?**

PLEASE ASK THE SECRETARY FOR FULL DETAILS

Telephone LEIGH 71084



## WELCOME TO OLDHAM . . .

For this afternoon's "warm-up" to next weekend's R.L. Cup tough 2nd round clash with Bradford Northern, we welcome equally difficult opposition in the form of our good friends from Oldham.

We are very pleased to have Oldham's players, officials and supporters at Hilton Park for this 2nd division clash which should be an exciting, entertaining affair.

Oldham are now going great guns at the top of the 2nd Division and are hopeful of promotion back into the upper ranks next season.

They began this season's campaign rather shakily but, after their slow start, they have settled down into one of the division's better sides, under the guidance of former St. Helens & Great Britain coach, Jim Challinor.

At full-back is Martin Murphy, who recently made his 1st appearance for England after many seasons classed as the best uncapped full-back in the League. Murphy, an ex Astley & Tyldesley R.L. amateur, gained useful experience 'guesting' in Australia for the summer.

Goal-kicker of the side is ex-Sale R.U. star Phil Larder, who has been regular centre for Oldham for several seasons.

The other regular centre is former Leeds favourite, and now a popular Watersheddings player, Tony Wainwright.

Welshman Mike Elliott, signed from Cwmellyn R.U. club over 11 years ago, is playing well on the wing, running with determination and always looking for tries.

Former Fairwater R.U. player Chris O'Brien and transfer-listed Ian Holland, the goal-kicking ex-Salford starlet, are also wingers.

Stand-off is David Treasure, ex-York and Bradford, currently in superb form and an integral part of the Oldham revival.

His half-back partner is clever little scrum-half Mick McCone, ex-Doncaster.

Four young backs who Oldham have a lot of hope for are strong running winger Steve Lund, full-back Gordon Pollard who comes from the Huddersfield area, centre Ian Taylor and Geoff Munro, the latter signed from Oldham 'B'.

Hooker Kevin Taylor, signed at 16 from local club Werneth, has made over 400 1st team appearances in his 12 seasons with Oldham.

Other forwards are local Fred Hall, a prop who began his professional career with Blackpool, useful prop Brian Hughes, stand-in goal-kicker Johnny Blair, an ex-Oldham junior, prop Ray Hicks who had trials at Leigh some time ago, 17-years-old Castleford based 2nd rower Paul Starbuck, Gareth Owen, former Tyldesley R.U. ace and son of ever-popular Stan Owen, Wigan based loose forward Johnny Farrell and free-transfer man Dickie Brown who has established himself firmly in the 2nd row with some good performances.

★★

**RUGBY LEAGUE CHALLENGE CUP — 2nd ROUND**

**SUNDAY, FEBRUARY 23rd, 1975 — Kick-off 3-30 p.m.**

**LEIGH v. BRADFORD NORTHERN**

Stand Tickets are now on sale at the Secretary's Office price 55p (Main Stand) and 50p (Supporters' Stand)

## P. T. H. Brooks Ltd.

Printers, Bookbinders & Stationers

57 BRADSHAWGATE,  
LEIGH

Tel. Leigh 73193

## F. TWIST & SON

Plastering & Wall & Floor Tiling

<sup>also</sup>  
"Spectrumite" Masonry Facing  
(Appointed Applicators)

**BREASTON HOUSE,**  
155 Warrington Road, Leigh  
Tel. Leigh 73919 (Day)  
Leigh 6584 (Evening)

**Tetley  
Bittermen.  
Join  
'em.**



**The  
inside  
story.**

**Manchester  
Evening News**

For all your Tyres, Batteries, Wheel  
Balancing, see the Specialists—

**Associated Tyres**

(TYRE REPAIR COMPANY)

COOK STREET,  
LEIGH, LANCASHIRE

Tel. 74712/74865

**H. S. JOHNSON**

General Builders

13 CHESTER ST., LEIGH

TEL. LEIGH 73073



FOLLOW YOUR TEAM  
IN COMFORT WITH

**LANCASHIRE UNITED**  
TRANSPORT LTD



Telephone ATHERTON 3501

**PRIVATE HIRE DEPT.**

*with all your enquiries*

**NEXT MATCH AT HILTON PARK . . .**

**Sunday, February 23rd, 1975**

**(2nd Round Rugby League Cup)**

**LEIGH v. BRADFORD N.**

KICK-OFF 3.30 p.m.

**T. O. BOYDELL**

Sheet Metal Workers and Welders  
Steel Prefabrications

Light Engineering

DERBY STREET, LEIGH, Lancs.

Tel. Leigh 71663

For Entertainment after the  
Match call in at the

**R.A.F.A. CLUB**

113 RAILWAY ROAD, LEIGH

TEL. 6838

Concerts, Bingo every Fri. Sat Sun.

**T.R.C.H. LTD.**

THOMAS ROBINSON

(Construction Holdings)

GROUP LTD.

HOOTEN LANE, LEIGH,

LANCS. Tel. Leigh 4125

**PETROL?**

Pennington Service Station

St. Helens Road, Leigh

Phone 72282

OPEN 24 HOURS

**QUAD** Green Shield **STAMPS**

The other ties in the 2nd Round are as follows and for a bit of a laugh the writer has made his forecasts which are in Capitals—

Salford v. LEEDS

Wakefield T. v. ST. HELENS

Rochdale H. v. OLDHAM

WIGAN v. Warrington

Hull v. WIDNES

Batley v. YORK

HULL K. R. v. Workington Town

—\*\*—

## JOHN WHITTLE . . .

Last week in the Doncaster match programme we included a welcome to John Whittle, our signing from Wigan, but because of pressure of space it was left out.

Our welcome to John, even though belated, is none the less most sincere. He is a player who has played many first team matches in Wigan colours but in recent months has not been able to impress the selectors sufficiently enough to gain him a regular place in the Wigan centre positions.

We liked the look of John's play on a couple of occasions this season especially when he played against the Leigh 'A' team some weeks ago.

Last Sunday in his first team debut for Leigh he showed some nice touches and he is a player who could be a great asset to the Club once he has settled down.

—\*\*—

## GORDON LEADBETTER . . .

We can now reveal that the mystery player who played on the wing at Workington as well as in a couple of 'A' team matches previously was former England Amateur open age winger Gordon Leadbetter.

Leadbetter impressed Leigh officials when playing against the Leigh 'A' team at Widnes earlier this season and when Widnes did not agree terms with the lad the Leigh Club stepped in to sign him for trials. As we have said previously he played one of his trials in the first team and he has now signed on professional forms for the Leigh Club.

We wish him well in his professional career.

—\*\*—

## PLEASE COME EARLY . . .

Rugby League attendances in recent seasons have not been too exciting. Here at Leigh especially this season, 'gates' have been very poor indeed.

Supporters have been able to walk leisurely up to the ground, pay at the turnstiles a few minutes before kick-off time without having to put up with a long queue.

Next Sunday it may be very different. With one of the best supported sides in the game visiting here it could be that long queues will develop just prior to the 3.30 p.m. kick-off.

Our advice to you all is PLEASE COME EARLY.



## RE-ARRANGED MATCHES . . .

To keep supporters informed we are giving an up to date list of the fixtures remaining for both the 1st and the 'A' teams.

One or two postponements, particularly involving the 'A' team have left players and supporters alike a little confused about the proposed new dates.

The remaining fixtures for the 1st team are:—

Sunday, February 23rd—	BRADFORD NORTHERN R.L. Cup 2nd Round) 3.30 p.m. ....	Home
Sunday, March 2nd—	BATLEY (2nd Division) 3.30 p.m. ....	Home
Sunday, March 9th—	R.L. CUP — Third Round.	
Wednesday, March 12th—	HULL K.R. (Second Division) 7.30 p.m. ....	Away
Sunday, March 16th—	OLDHAM (2nd Division) 3.30 p.m. ....	Away
Sunday, March 23rd—	WHITEHAVEN (2nd Division) 3.30 p.m. ....	Home
Friday, March 28th—	SWINTON (2nd Division) 3 p.m. ....	Away
Sunday, March 30th—	DONCASTER (2nd Division) 3 p.m. ....	Away
Sunday, April 6th—	BLACKPOOL (2nd Division) 3.30 p.m. ....	Home

The remaining fixtures for the 'A' team are:—

Saturday, February 22nd—	WIDNES 'A' (Lancashire Combination) 3 p.m. ....	Home
Friday, February 28th—	SALFORD 'A' (Lancashire Combination) 7.30 p.m. ....	Home
Saturday, March 8th—	ROCHDALE 'A' (Lancashire Combination) 3 p.m. ....	Home
Friday, March 21st—	ST. HELENS 'A' (Lancashire Combination) 7.30 p.m. ....	Home
Friday, April 4th—	WARRINGTON 'A' (Lancashire Combination) 7.30 p.m. ....	Away

— ★ ★ —

## THE 'DRAGON' HAS TEETH . . .

by Trevor Watson, Yorkshire Evening Post

Castleford director Ronnie Simpson is a loyal tyke but has adapted to the role of a Welshman with rare enthusiasm since being appointed team manager of Wales.

He has been on the Castleford board for 25 years, including 15 as vice-chairman or chairman, and last summer ended his two-years stint as chairman of the Rugby League Council.

Mr. Simpson, who has seen the Wheldon Road club rise from the ranks of strugglers to become one of the most respected teams in the game, is confident that the Welsh start will be at the top.

Since his appointment much of his time has been spent travelling around the League checking on the 54 players who are Welsh born or have suddenly discovered they have traces of the 'Dragon's Blood' in their veins.

Some of the names were, of course, well-known and one or two others were surprising, to say the least, but Mr. Simpson diligently checked each one

# Be a Leigh Reporter Supporter

Are you a die-hard Leigh fan? Then you must be a Leigh Reporter supporter.

For the Reporter keeps you up to date with the Hilton Park action, fills you in on the inside news stories.

**FOLLOW LEIGH, AND THE REPORTER FOR THE BEST  
IN RUGBY LEAGUE ACTION.**

**THERE'S . .**

- ACTION PICTURES AT THEIR BEST.
- THE £300 REPORTER PLAYER OF THE SEASON AWARD SCHEME.

And to back up the finest Rugby League coverage in the area we keep you in touch with the local sports scene.

For anglers there's the weekly Benny Ashurst column.

Add to this a comprehensive news coverage that covers birth, marriages and deaths, courts, council news and views.

Then let's not forget the other services the Reporter provides such as:

- A comprehensive armchair guide for the home hunters.
- The free Under-a-Fiver bargains column.

You can pick up the Reporter if you are looking for a new job, another car.

**DON'T FORGET . . . IF YOU FOLLOW LEIGH, IT'S NATURAL THAT YOU BECOME A REPORTER SUPPORTER NOW.**





COME TO LEIGH MOTORS FOR  
A CAR YOU CAN DEPEND ON!

Choose from a wide selection of Hillman,  
Sunbeam, Simca, Avenger and Chrysler  
\* CHRYSLER MAIN DEALER \*

**LEIGH MOTORS**

LEIGH MOTORS LTD.,

BROWN STREET NORTH

(Formerly Leigh Railway Yard) Leigh.

Tel.: Leigh 3264

Want to Celebrate after the Game?

Call in at the

**GARRICK CLUB**

REAR OF LEIGH ROAD, LEIGH

TEL: 72915

**NOBLES**

FOR ALL TYPES OF SPORTS  
TROPHIES, WATCHES & JEWELLERY

**NOBLES JEWELLERS**

MARKET STREET, LEIGH.

Tel. Leigh 6622

**George & Dragon**

WARRINGTON RD., GLAZEBURY

Tel: CULCHETH 3296

Soups, Snacks & Sandwiches  
served at the Bar 12-2p.m.

**DINNER SERVED NIGHTLY**

Tuesday to Saturday 8 p.m. - 9-30 p.m.

Luncheons - Monday to Friday 12- 2-15p.m.

Your Hosts - Ralph & Betty Daniels

LARGE CAR PARK

## TIMMS OF LEIGH

MAIN



DEALERS

TEL. 73401

**Leigh 4**

1. Hogan

2. Leadbetter

3. Stacey *2 goals*

4. Whittle

5. Walsh

6. Riding

7. Sayer

8. Fairbrother

9. Wheeler

10. Fletcher, G.

11. Rowley/Platt

12. Jones

13. Macko

Substitutes—

14. McAtee

15. Lester

*Full-Back*

*Right Wing*

*Right Centre*

*Left Centre*

*Left Wing*

*Stand-off*

*Scrum-Half*

*Prop Forward*

*Hooker*

*Prop Forward*

*2nd Row Forward*

*2nd Row Forward*

*Loose Forward*

**Oldham 18**

1. Blair *49 2 dy*

2. Elliott

3. Larder *Exy goal*

4. Murphy

5. Barton

6. Treasure *6 y*

7. ~~McCane~~ *Brown*

8. Hughes

9. Taylor

10. McCracken

11. Hall

12. ~~Brown~~ *Reynolds*

13. Farrell

Substitutes—

14. ~~Reynolds~~ *Jackson*

15. Welding

Referee: Mr. J. E. JACKSON (Pudsey)

T.J.'s: W. J. Greenhalgh (Wigan) H. Worth (Widnes)

**A & B MOTORS (Newton-le-Willows) LTD.**

NEWTON-LE-WILLOWS

Telephone: 4411 (10 Lines)

Your Datsun Dealer for Wigan, Warrington, St Helens, Newton

**A & B CARS (Newton-le-Willows) LTD.**

Volvo Specialists, Sales and Service. Aston Martin Distributors  
for Lancashire, Cumberland and Westmorland.

And the Isle of Man.

## HOME OR AWAY?

Save for your Holidays

with

**LEIGH TRUSTEE  
SAVINGS BANK**

Fazackerleys of Leigh

FITTED CARPETS &  
FITTED BEDROOM SPECIALISTS

Silk St., Leigh King St., Leigh

Tel. Leigh 73324 - 71840

**B. FORSTER & CO.**

CENTRAL MILL

LEIGH

TEL. LEIGH 73251

**Taylor's (Confectioners) Ltd.**

Wedding and Birthday Cakes  
a Speciality

Dances & Parties catered for

25 Bradshawgate, Leigh. Tel. 71643

7 Railway Road, Leigh. Tel. 73694

115 Railway Rd., Leigh. Tel. 73737

2 Victoria Street, Leigh. Tel. 73644

Reg. Office—Hill Street, Leigh

Tel. Leigh 71643 and 73694

**HERBERT  
HULMES**

Commission Agents

Member of N. B. P. A.

Head Office: 73 King St., Leigh

Tel: 73845 and 73782

and 73211

And other branches at Leigh, Bedford, Louton



# TBA

**Industrial Products Limited**  
LEIGH ROAD, HINDLEY GREEN, Nr. WIGAN

## Vacancies for Men

**GOOD CONDITIONS**

**SECURITY**

**VARIETY OF SHIFTS & JOBS**

**INTERESTING WORK**

Don't Hesitate — Call for Immediate Interview

9 a.m. to 11 a.m.

1 p.m. to 3 p.m.

or Telephone for appointment Wigan 55166

**TURNER  
& NEWALL  
LIMITED**

## COMPETITION CORNER No. 11 . . .

We had a good response to our Competition No. 10 which appeared in the Doncaster match programme last Sunday.

The answers to the competition were as follows: Mystery Player . . Frank Paulger, an Australian who guested with Leigh a couple of seasons ago. The deliberate mistake appeared on Page 7 under the heading 'A Cup for Clangers'. We stated in the next to the last paragraph that in the mix up over the Cup Draw three years ago that Castleford was the only number left in the bag at the end of the draw, when the Leigh ball had fallen on the floor. The last ball in the bag actually belonged to Leeds and not Castleford.

The first two correct answers were sent in by Linda Taylor of 24 Brookfield Street, Leigh and William Jones of 26 Chaucer Grove, Leigh. These two people will be contacted within the next day or so and invited to select a Leigh match (home or away) and they will receive two tickets for the match of their choice.



The rules are the same today for our Competition Corner No. 11. First of all identify the player pictured and then read carefully through the programme to find the writer's deliberate mistake.

Send your entries on the official form below (Plain paper entries cannot be accepted). Two stand tickets for any Leigh game (home or away) to the TWO winners.

send to:—

COMPETITION CORNER No. 11.  
LEIGH FOOTBALL CLUB LTD.,  
HILTON PARK, LEIGH.

*Picture by courtesy of the Lancashire Evening Post and Chronicle.*

The player photographed is .....

The deliberate mistake is .....

Name of Sender .....

Address .....

Please return to Competition Corner No. 11 Leigh Football Club Ltd., 'Hilton Park', Leigh.

IN THE EVENT OF ANY DISPUTE, THE SECRETARY'S DECISION IS FINAL.



He says: "The choice we had was tremendous, when you think we can afford to pick a player like Maurice Richards as sub. Certainly some of the names that cropped up must have knocked England's chances back a bit.

"There is a good deal of experience in the pack and a lot of class in the backs, a great combination. I am really looking forward to the challenge".

Mr. Simpson, who was with the successful 1972 Great Britain World Cup team in France, added: "There was never any question of the Welsh being there just to make up the numbers.

"We had slight doubts about the half-backs but when Peter Banner turned out to be available that was that. All we ask now is to be able to select from strength.

"I'm sure when these lads put on the red jersey of Wales there'll be no need to motivate them; the spirit will be there before we start, and the rest had better watch out, I'm not frightened of taking this team anywhere".

It is a fair warning to the other countries and Mr. Simpson adds another "Naturally, I'm a Yorkshireman, but I'm a Rugby League man at heart and I don't mind changing nationalities for a few months to bring the Welsh team back to life".

★★

## GRAND NATIONAL DRAW, 1975 . . .

With Red Rum winning at Haydock Park in fine style last week most racing enthusiasts have begun to talk about this year's Grand National. "Will Red Rum win it for the third time?" they ask.

Within the next day or so the tickets for our Grand National Draw will be on sale. Most of our Pools Agents will be in possession of them and we would advise you to make sure you get a book of tickets because we understand it to be the biggest Grand National Draw in the North of England.

The prizes are as follows:—First Prize £100; Second Prize £40; Third Prize £20; Fourth Prize £10.

There will be a prize of £1 for every horse drawn and for each horse finishing the stern Aintree course there will be bottle of whisky.

Tickets will be 3 for 10p.

The draw will be run on the same lines as last year's Derby Draw but for anyone not sure on how the draw works we are pleased to explain.

All the declared runners will be listed and then a number drawn alongside each horse. That horse will represent the holder of the ticket bearing the number.

EXAMPLE:—

If you are holding a ticket which number is alongside 'Red Rum' then 'Red Rum' will be your horse in the race. If it wins then of course you will be the winner of the first prize of £100, and so on.

★★

## THE GREEN GREEN GRASS OF 'HILTON PARK'

Although we have not been able to boast too much about the performances of the team during this year it can be said that we have something to boast about in the condition of our playing area, which continues to be one of the best in the game.

Today's visitors, Oldham, have had more than their fair share of worries because of their ground conditions and no doubt they will be envious of our 'park' this afternoon.

We are, in fact, very proud of our playing area and we would like to give a word of praise to our groundsman Bert Battersby and his staff for the tremendous work they put in to keep the pitch in its present excellent condition.

Even at the season's end we shall find plenty of green grass which says plenty for the experience and skill of our ground staff.

## Browse around a Broseley home

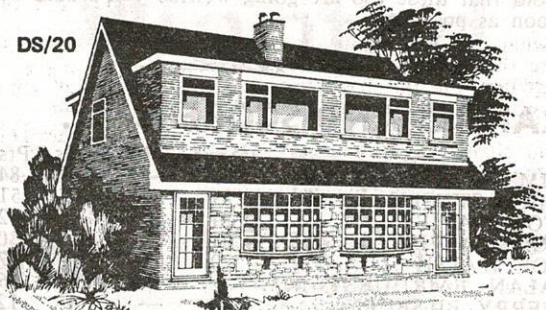

DS/20

This semi-detached dormer is designed to make the most imaginative use of space. A hall leads into a large lounge with a dining area. The kitchen, with fitted units, is conveniently placed beside the dining area. Upstairs there are three bedrooms and a bathroom. The attractive bow window in the lounge looks out over the ready turfed garden.

PRICES START AT AROUND **£7,000**

Developments at

Wigan Road, **ATHERTON**

Liverpool Road, **ASHTON-IN-MAKERFIELD**

Berry Fold, **TYLDESLEY**

Atherton Road, **HINDLEY GREEN**

Pemberton Road, **WINSTANLEY**

Alexandra Road, **HORWICH**

# BROSELEY

...for fresh ideas in living

**MORTGAGES AVAILABLE**

Only £25 Reservation Fee

**BROSELEY** Homes Tel. Leigh 71871 or 74399



## WEMBLEY TICKETS, 1975 . . .

We have received many enquiries about the availability of stand tickets for the Rugby League Cup Final at Wembley on May 10th.

The fact is that all Stand tickets have been sold and only Ground tickets at £1 are available.

These can be obtained from the Rugby League Headquarters at 180 Chapeltown Road, Leeds LS7 4HT.

We are told that these too are going well so you would be well advised to apply as soon as possible.

—\*\*—

## APPEARANCES AND SCORERS. . .

	Apps.	Tries	Goals	Pts.
JIM FIDDLER .....	13	—	43*	84
MICK STACEY .....	23	4	20	51
TOM DAVIES .....	24	10	1	32
JOHN DAVIES .....	24	10	—	30
JOE WALSH .....	20	9	—	27
ALAN FAIRHURST .....	4	—	8	16
TERRY BILSBURY .....	10	—	4	12
ALVA DRUMMOND .....	4	3	—	9
MICK HOGAN .....	25	3	—	9
CLIFF SAYER .....	26	3	—	9
TOMMY MARTYN .....	13	3	—	9
JOHN WHITTLE .....	1	2	—	6
TONY BYRNE .....	12	2	—	6
DAVE MACKO .....	15	2	—	6
ALF WILKINSON .....	6	1	—	3
KEITH CLARKE .....	7	1	—	3
DENIS BOYD .....	19	1	—	3
FRANK BARROW .....	18	1	—	3
JOHN McATEE .....	7	1	—	3
MICK COLLINS .....	19	1	—	3
ALLAN ROWLEY .....	24	—	—	—
ALAN RIDING .....	14	—	—	—
BILLY BARROW .....	12	—	—	—
DENIS CARDEN .....	10	—	—	—
JEFF SHIELD .....	8	—	—	—
DON WHEELER .....	7	—	—	—
MAURICE PLATT .....	6	—	—	—
JOHN RANDALL .....	5	—	—	—
DEREK FLETCHER .....	5	—	—	—
CLIVE JONES .....	4	—	—	—
KEITH FAIRBROTHER .....	4	—	—	—
ERIC HUGHES .....	4	—	—	—
GEOFF FLETCHER .....	4	—	—	—
STEPHEN GRIMSHAW .....	3	—	—	—
BRIAN ROBINSON .....	1	—	—	—
LES FISHWICK .....	1	—	—	—
ROY LESTER .....	1	—	—	—
DAVE CAREY .....	1	—	—	—
JOE WOOD .....	1	—	—	—

(\*inc. 2 drop goals)

LEIGH RUGBY DEVELOPMENT ASSOCIATION

# Agents Wanted

— GENEROUS COMMISSIONS —

RING LEIGH 71084 TODAY

WHY NOT TRY . . .

## GRANNY SMITHS PASTRY & CAKE MIXES

For Delicious Home Baked Pies — Available from—  
YOUR GROCERS & SUPERMARKETS  
EVERYWHERE.

Telephone Atherton 3354, 5517, 6886 & 6887

**M & S MOTORS [Leigh] Limited.**  
**S & W GARAGES [Atherton] Limited.**

PRINTSHOP LANE, ATHERTON, M29 9BJ, LANCs.

\* \* \*

PRIVATE & COMMERCIAL VEHICLE REPAIRERS

LIGHT & HEAVY BREAKDOWN SERVICE

TRAILER MANUFACTURERS

BRAKE TESTING SERVICE

STEAM CLEANING

HAULAGE CONTRACTORS



## FIRST TEAM FIXTURES

Date	Opponents	Ground
1974		
August—		
16—	Widnes (A. & B. Cup)	A 16-21
23—	N. Hunslet	H 13-13
26—	Swinton	H 10-2
30—	Barrow (L. Cup)	A 31-10
1st Round		
September—		
7—OPEN DATE		
15—	Hull	A 16-8
21—	Doncaster	H 43-0
24—	Bramley (Floodlit)	H 19-5
29—	Wakefield T.	A 10-44
Players No. 6 1st Rnd.		
October—		
2—	Bramley (Floodlit)	A 9-15
4—	Whitehaven	A 2-14
9—	Widnes	H 5-8
(Lancs. Cup Semi-Final)		
12—	Huyton	H 20-12
20—	Blackpool B.	A 25-9
22—	Dewsbury (Floodlit)	A 14-8
26—	Huddersfield	H 7-15
November—		
3—	Huyton	A 3-9
9—Players No. 6 - 2nd Rd.		
15—	Barrow	A 8-5
19—	Rochdale H.	H 8-0
23—	Hull K. R.	H 5-25
December—		
1—	N. Hunslet	A 8-20
7—	Hull	H 6-0
10—	Warrington	
(B.B.C. 2 Semi.)		
15—	Huddersfield (P'oned)	A 0-32
22—	Huddersfield	A 0-36
26—OPEN DATE		
29—	Barrow	H 8-20
1975		
January—		
5—	Hull K.R.	A Post.
12—	Workington	H
19—	Batley	A 20-7
25—OPEN DATE		
February—		
2—	Workington	A 0-7
9—	Doncaster (R.L. Cup)	H
16—	Oldham	H
22—	R.L. CUP - 2nd Round	
March—		
2—	Batley	H
8—OPEN DATE		
15—	Oldham	A
23—	Whitehaven	H
28—	Swinton	A
30—	Doncaster	A
April—		
6—	Blackpool B.	H

## 'A' TEAM FIXTURES

Date	Opponents	Ground
1974		
August—		
14—	Widnes (Farrell Cup)	H 21-13
24—	Rochdale	A 4-21
31—	Barrow	H 14-13
(Shield 1st Rnd. 1st Leg)		
September—		
14—	Barrow	A 8-38
Shield, 1st Rnd., 2nd Leg.		
21—OPEN DATE		
27—	Swinton	A 17-33
October—		
5—OPEN DATE		
12—	Huyton	A 16-8
19—	Blackpool	H 46-11
25—	Widnes	A 13-6
November—		
2—	Huyton	H 10-9
9—	St. Helens	A 2-49
16—	Barrow	H 25-15
22—	Salford	A
30—	Blackpool	A Post.
December—		
7—	Wigan	A Post.
14—	St. Helens	H Post.
21—OPEN DATE		
28—	Barrow	A 19-16
1975		
January—		
2—	Wigan	H 3-10
4—	Warrington	H 7-24
10—	Oldham	H
18—	Swinton	H
24—	Warrington	A
February—		
1—OPEN DATE		
8—	Salford	H
15—	Oldham	A
22—	Widnes	H
March—		
1—OPEN DATE		
8—	Rochdale	H
15—	OPEN DATE	
22—	OPEN DATE	
29—	OPEN DATE	

# ONLY THE RUGBY LEAGUER

IS DEVOTED ENTIRELY TO RUGBY LEAGUE

AND HAS BEEN FOR OVER A QUARTER OF A CENTURY

Ask your newsagent to order your copy today or complete the order form for delivery to your home.

TO THE PUBLISHER, RUGBY LEAGUER, 164 COLLEGE STREET, ST. HELENS, LANCs, NA10 1TT.

You save money by taking the full season's subscription.

PLEASE POST RUGBY LEAGUER TO ME EACH WEEK FOR 13 WEEKS (90p) 26 WEEKS (£1.80) FULL SEASON (£2.60)

As the Leaguer is not published during the close season the subscription will continue into the following season until the expiry date.



ENCLOSE REMITTANCE VALUE

NAME \_\_\_\_\_

ADDRESS \_\_\_\_\_

\_\_\_\_\_

\_\_\_\_\_

(BLOCK LETTERS PLEASE)  
(Delete words not applicable)

EVERY WEDNESDAY THROUGHOUT THE SEASON

4p

OVERSEAS RATES AUSTRALIA & NEW ZEALAND  
13 weeks (£1.80) 26 weeks (£3.60) season (£5.60)